

All Connectors

1200 Series Coax Combo D-Sub - Vertical PCB Type

Material:

Shell: Steel w/ Tin Plated (optional Zinc plating)
Signal Contacts: Beryllium Copper
Coaxial Contacts: Brass
Signal Contact Plating: 5u" Gold
Coaxial Contact Plating: 15u" Gold
Contact Underplating: 100u" min. Nickel
Insulation: PBT & 30% glass fiber reinforced thermo plastic
 UL94V-O?/font>UL File# E107536, material D202G30

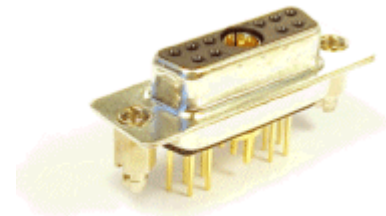

Electrical:

Signal Contact Rating: 7.5 Amp
Coax Impedance: 50 ohm or 75 ohm
Coax VSWR: Less than 1.3 - 1.0 up to 500 MHZ
Coax Insertion Loss: 0.1 dB loss at 55 MHZ
Dielectric Withstanding: 1500V at sea level
Operation Temperature: -55°C to +105°C



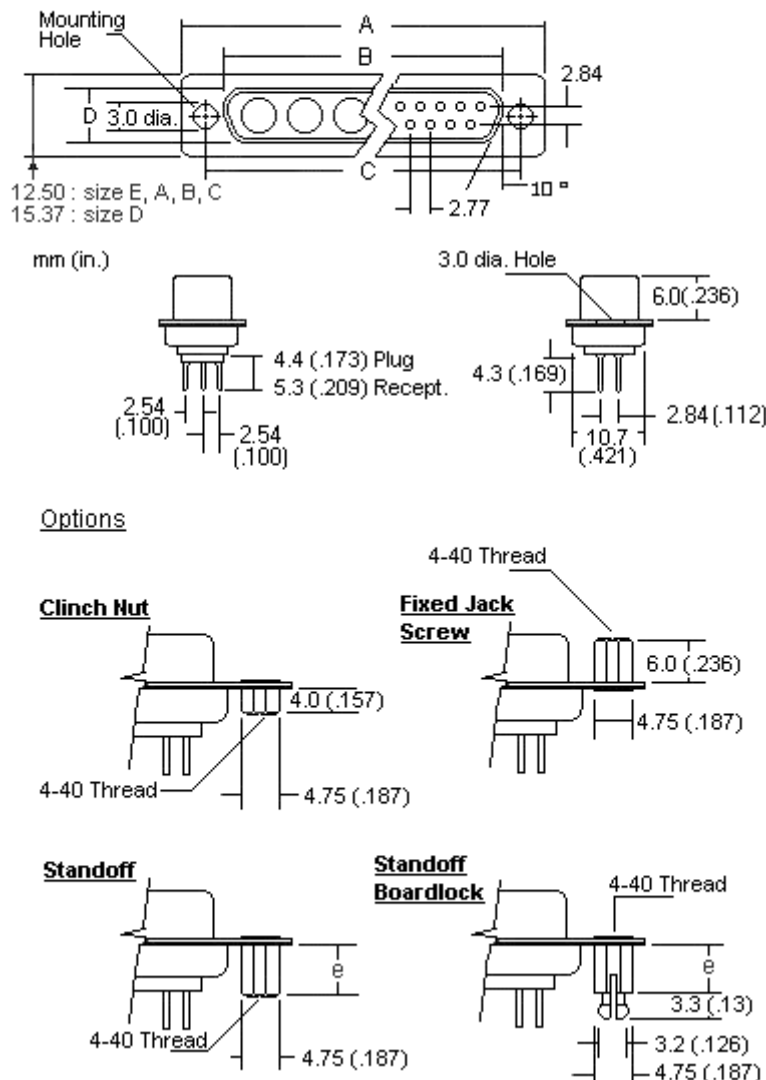



Mechanical Specification and Mounting Option:

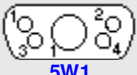

Option	Mea. "e"	Part Number (Suffix)
3.0 dia Hole	-	(Standard)
Fixed Jack Screw	-	-2NA
Clinch Nut	-	-2N
Standoff	6.0	-2NB
	6.4	-3NB
	7.62	-7NB
Standoff Boardlock	6.0	-2ND
	6.4	-3ND
Standoff Boardlock with Jackscrews	7.62	-7ND
	6.0	-2NJ
	6.4	-3NJ
	7.62	-7NJ

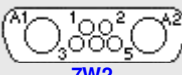
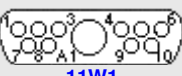
Ordering Part Numbers

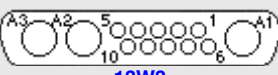
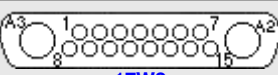
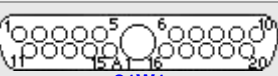
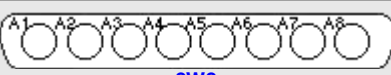
Effective Apr. 15, 2001 part numbers for this series has changed. The part numbers below are the new P/N.

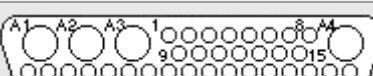
Shell Size	Contact Arrangements (Front view of Plug/ Rear view of Recept)	Plug \ Recept	Part Number		Dimensions mm			
			50 ohm	75 ohm	A	B	C	D
E	 2W2	Plug	1250-22T	1270-22T	30.81	16.92	24.88	8.36
		Recept	1251-22T	1271-22T		16.33		7.87
	 5W1	Plug	1250-51T	1270-51T		16.92		8.36
		Recept	1251-51T	1271-51T		16.33		7.87
A	 3W3	Plug	1250-33T	1270-33T	39.14	25.25	33.32	8.36
		Recept	1251-33T	1271-33T		24.66		7.87
	 3V3	Plug	1250-23T	1270-23T		25.25		8.36
		Recept	1251-23T	1271-23T		24.66		7.87
	 7W2	Plug	1250-72T	1270-72T		25.25		8.36
		Recept	1251-72T	1271-72T		24.66		7.87
	 11W1	Plug	1250-11T	1270-11T		25.25		8.36
		Recept	1251-11T	1271-11T		24.66		7.87
B	 5W5	Plug	1250-55T	1270-55T	53.04	38.96	47.04	8.36
		Recept	1251-55T	1271-55T		38.38		7.87
	 13W3	Plug	1250-13T	1270-13T		38.96		8.36
		Recept	1251-13T	1271-13T		38.38		7.87
	 17W2	Plug	1250-12T	1270-12T		38.96		8.36
		Recept	1251-12T	1271-12T		38.38		7.87
	 21W1	Plug	1250-21T	1270-21T		38.96		8.36
		Recept	1251-21T	1271-21T		38.38		7.87
C	 8W8	Plug	1250-88T	1270-88T	69.32	55.42	63.50	8.36
		Recept	1251-88T	1271-88T		54.84		7.87
	 21W4	Plug	1250-24T	1270-24T		55.42		8.36
		Recept	1251-24T	1271-24T		54.84		7.87
D	 36W4	Plug	1250-34T	1270-34T	66.93	52.81	61.11	11.07
		Recept	1251-34T	1271-34T		52.43		10.74

- * Part Numbers includes Housing, and Preloaded Signal Contacts and Coaxial Contacts (Preloaded).
- * Housing with Preloaded Signal Contacts and Coaxial Contacts may be ordered separately. Contact AllConnectors to Order.
- * To order Coaxial Contacts only separately, see table below for Part Numbers.
- * Economic stamp pin type on signal contacts available.
- * Zinc shell, Insulation color and gold on contact options are available. Contact AllConnectors for more info.

Coaxial Contacts - Vertical PCB Type

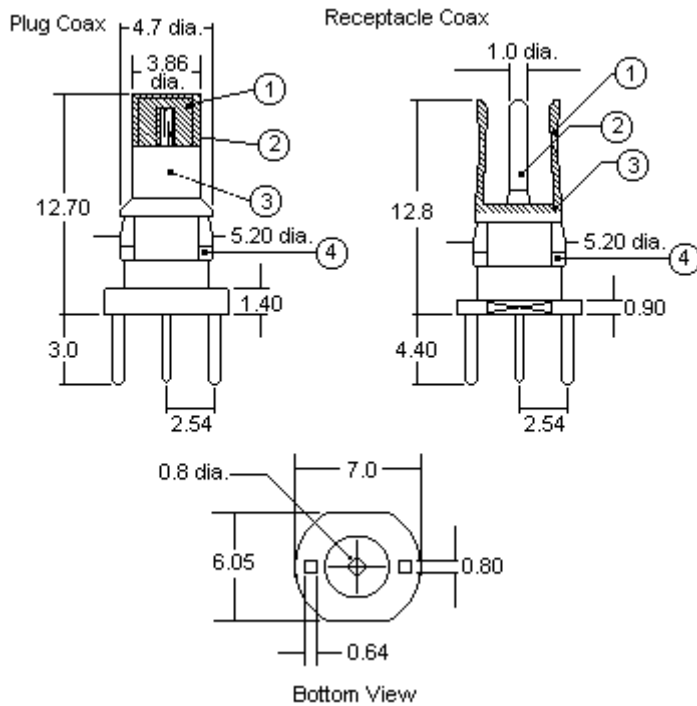

Part Number (For Ordering Individual Contacts)		
ohm	Plug Coax	Recept Coax
50	1250-00	1251-10
75	1270-00	1271-10

No.	Description	Material	Coments
1	Center Contact	Brass	0.000015" Gold over 0.000050" min. Nickel
2	Outside Contact	Brass	0.000015" Gold over 0.000050" min. Nickel
3	Insulator	Teflon	UL94V-O; White
4	Lock Link	Copper Alloy	Nickel Plated

AllConnectors
 Kettnerstr. 25
 70794 Filderstadt
 Tel.: 0711 7009503
 Fax: 0711 7009504
 info@allconnectors.de
 www.allconnectors.de